

ENGLISH

Product content	3
Button performance	3
Power on / Power off	3
Bluetooth® connection	4
True Wireless Stereo connection.	4
FM Radio	5
USB/MicroSD and Line in	5
Modes	6
Change playback folder.	6
Call control (Handsfree function)	7
LED Lights modes	8
Battery charging	8
Reset (Force Reset)	9
Care and maintenance	9
Technical specs	9
Audio	9
Bluetooth connectivity	9
True Wireless Stereo compatible with:	9
Audio inputs	9
FM radio	9
External memory player	9
Battery	9
Other	10
Weight and dimensions	10
Warranty	10

ENERGY  SISTEM

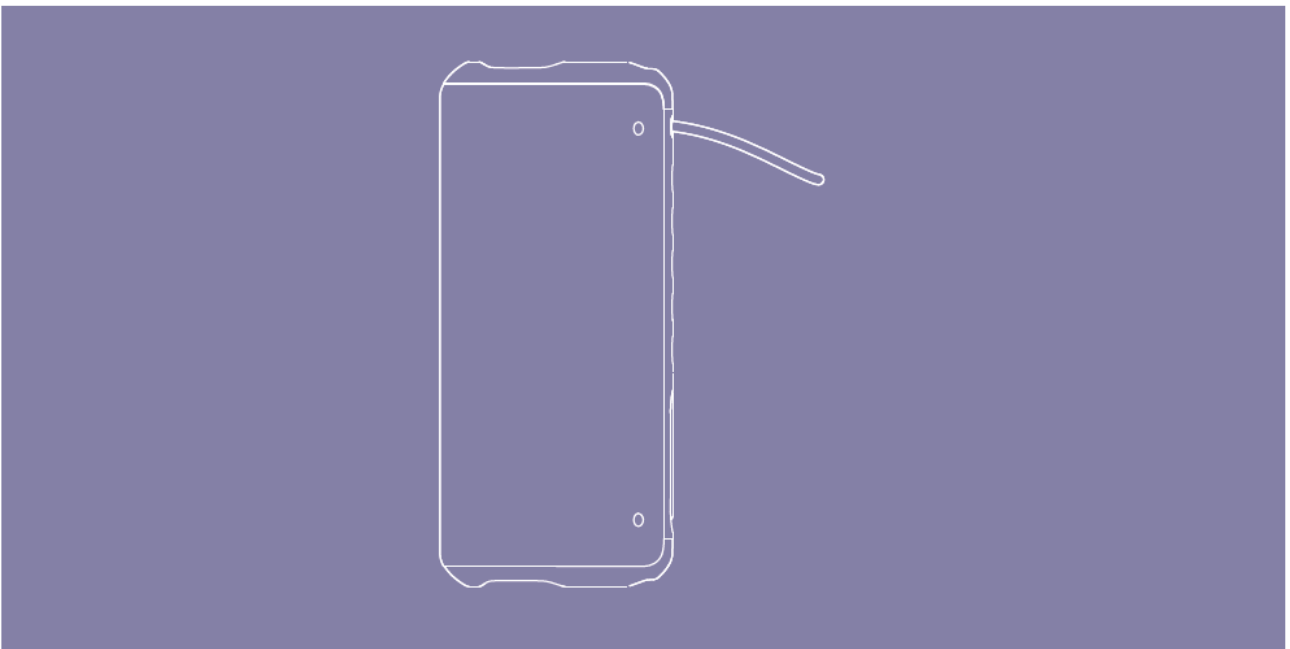

Thank you for trusting us with your new *Soundbliss/TempoRave Speaker*. We hope you enjoy it.

Product content

- Soundbliss/TempoRave Speaker
- USB type-C charging cable
- Quick user guide

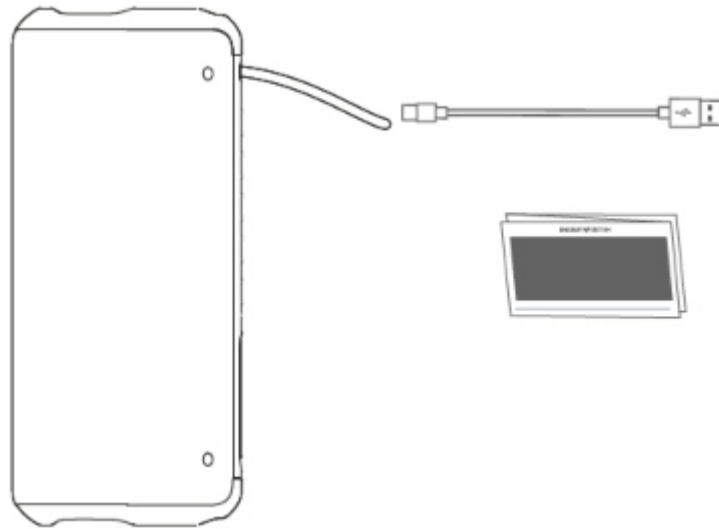

Button performance

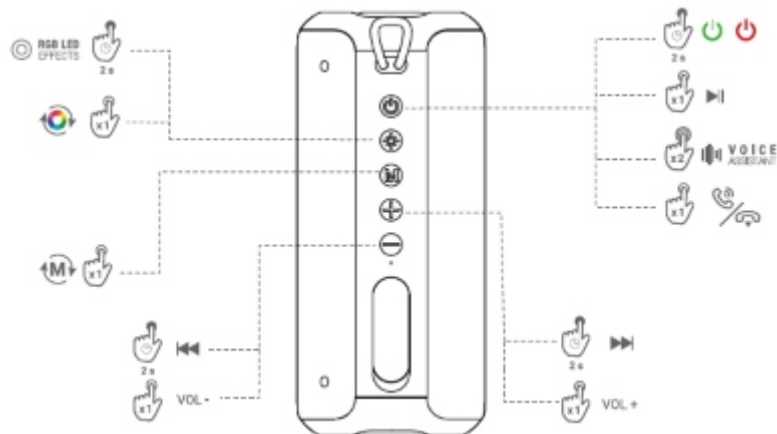

Power on / Power off

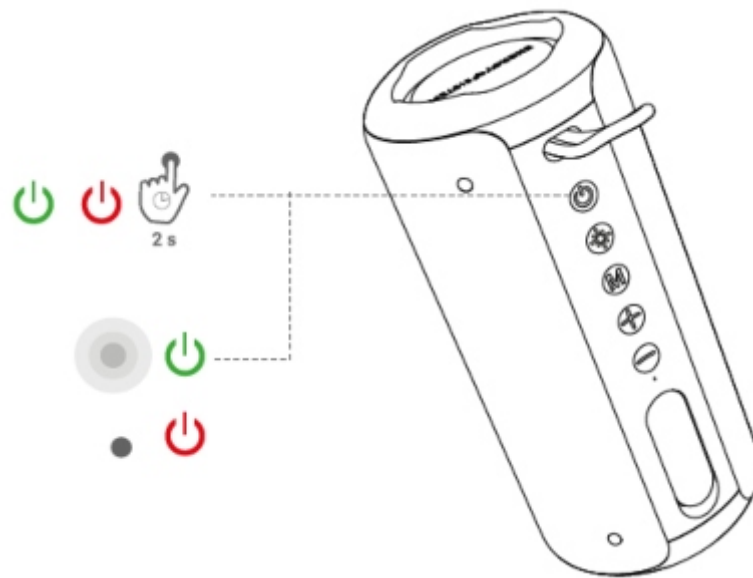

Bluetooth® connection

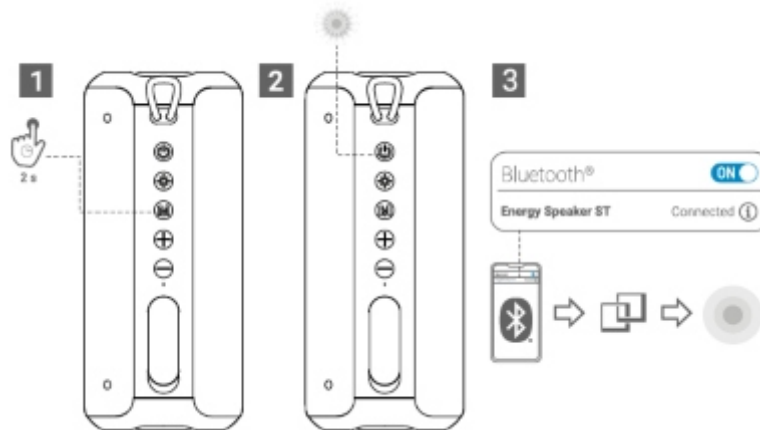

True Wireless Stereo connection.

Turn on both speakers and without connecting either one via Bluetooth to the Smartphone, double-tap the M button on one of them. You will hear a sound indicating that both speakers have paired with each other. Then pair Bluetooth with your Smartphone or other transmitting device to start playing music.

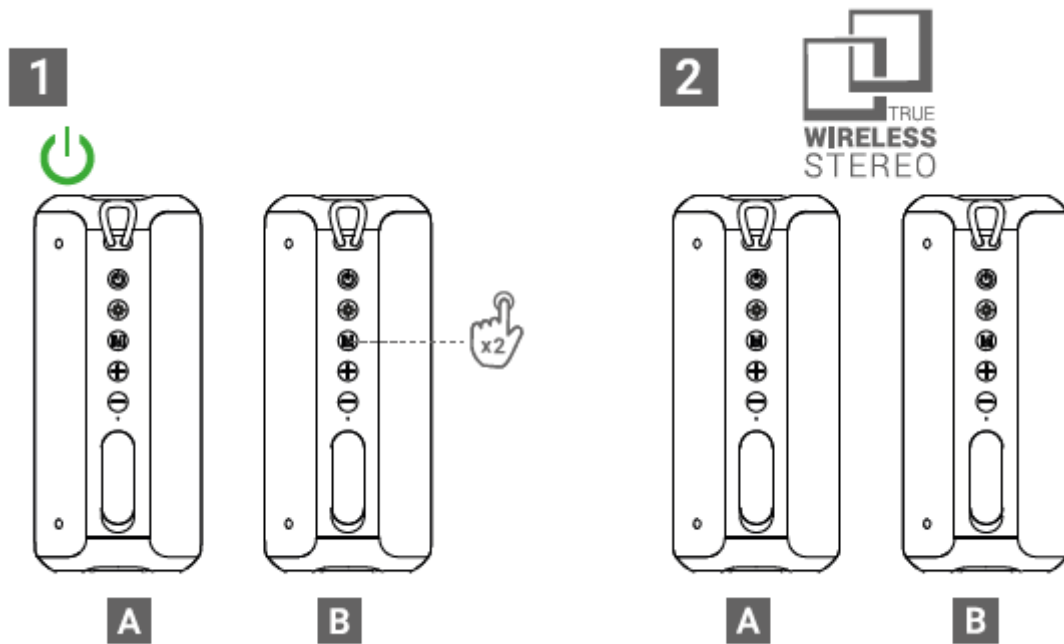

Note: This function is only available in Bluetooth® mode. In all other playback modes (USB, microSD or Aux-in) a TWS connection is not possible.

FM Radio

Switch to FM mode by pressing the M button (one click). Then press and hold the M button again for 2 seconds to start the FM stations scan, this may take a few minutes. Once the stations scan is complete, press and hold the + or - button to move forward or backward respectively.

Note: To improve the reception of FM stations you can connect the included charging cable to the speaker, leaving the other end (USB type A) free, without connecting it to any other device. In this way the cable will perform the function of an external FM antenna.

USB/microSD and Line in

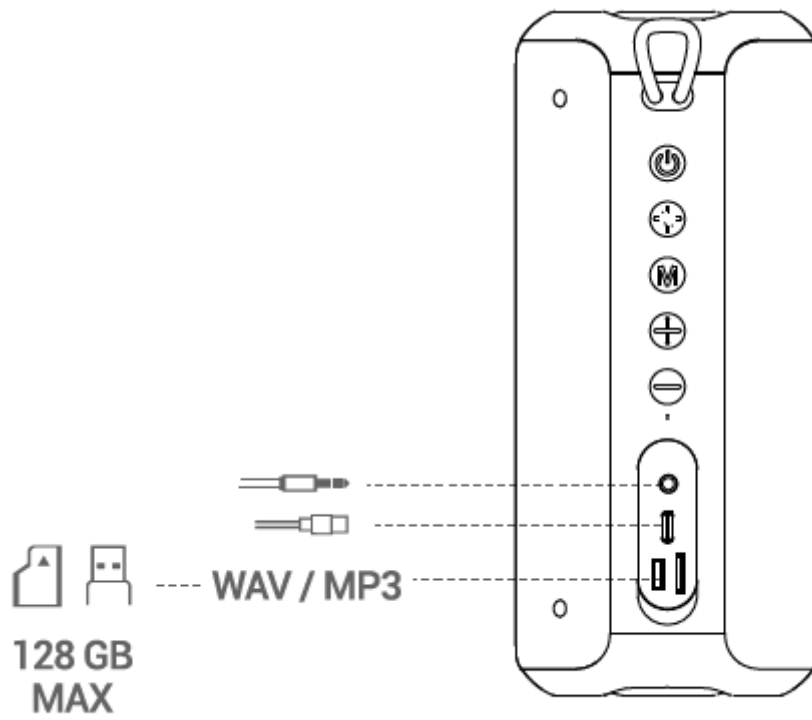

Modes

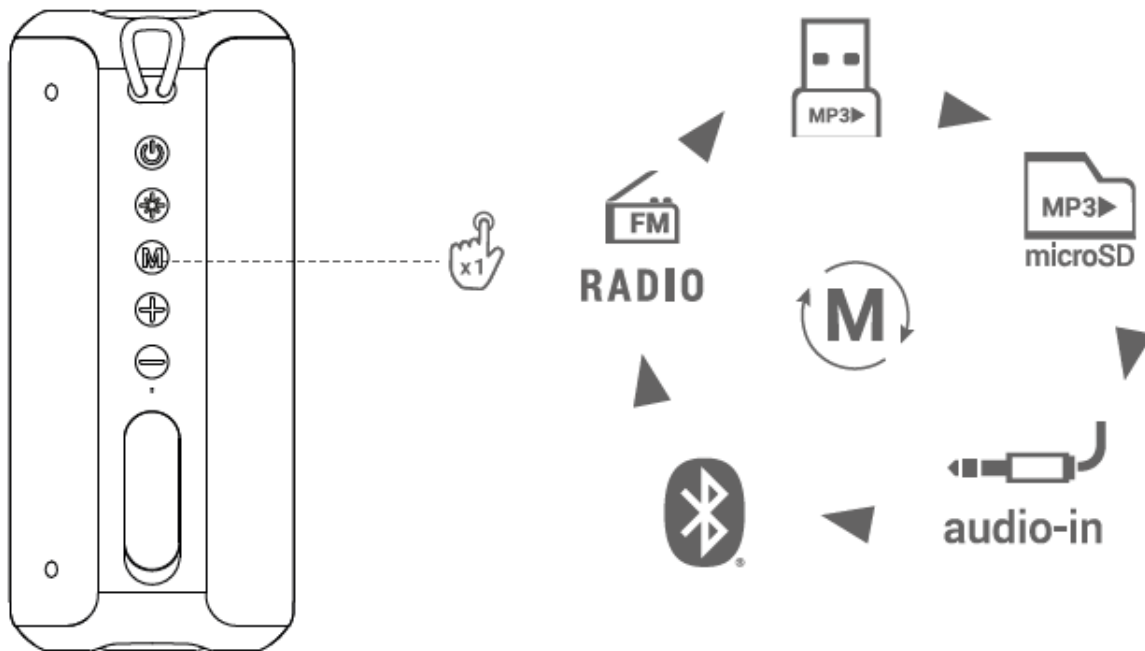

Change playback folder.

You can make folder jumps in the USB and microSD external memory reader. To do this, press and hold the M button.

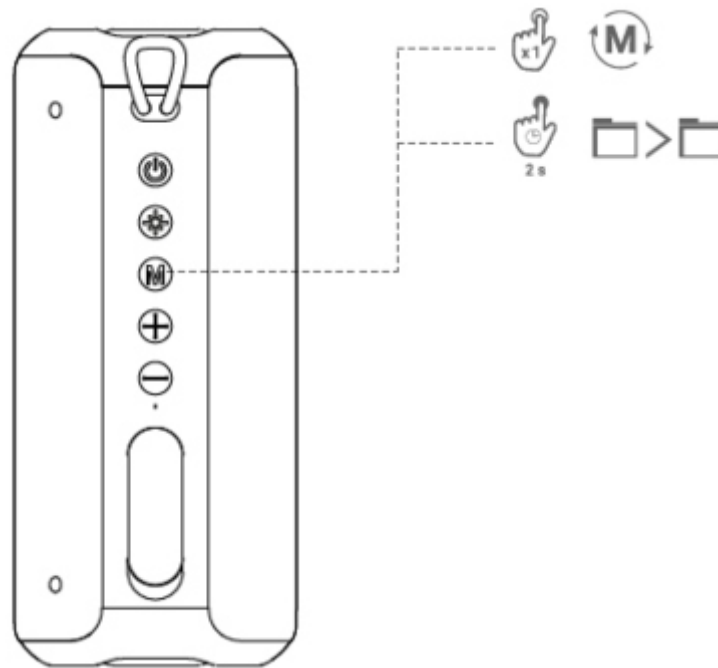

The folders and files contained in the root of the external USB and microSD memory sticks are read in chronological order of writing and the songs contained in the folders are read in alphabetical order.

A diagram of the reading order is shown below:

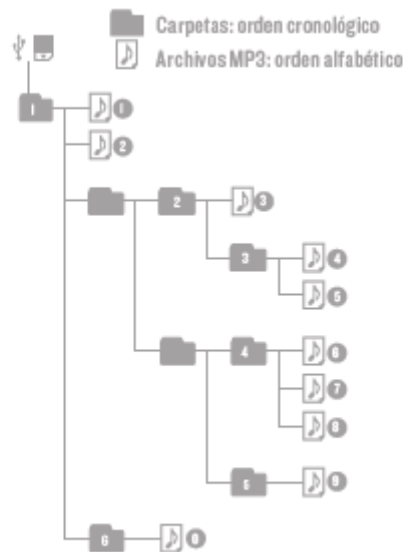

Note: *Input mode (Line in or Audio input)* -In this mode it is not possible to control playback from the speaker itself. In this mode of use it is not possible to control the playback from the speaker itself, and it is necessary to do so from the connected external player. The maximum volume depends directly on the power of the signal supplied by the transmitting device.

Call control (Handsfree function)

Once you have paired your *Soundbliss/TempoRave Speaker* with your Smartphone you can control your calls from the speaker itself.

When you receive a call, the song you are listening to will stop and the ringtone will sound. To answer the call press the

On/Off/Play/Pause/Call button, and to end the call press the On/Off/Play/Pause/Call button again.

Note: When you receive a call and you are using the TWS function, you will only hear the conversation through the speaker connected to your Smartphone.

LED Lights modes

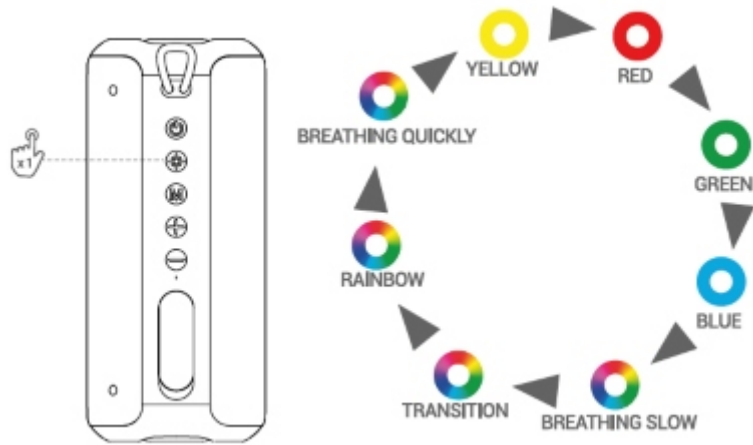

Once your *Soundbliss/TempoRave Speaker* is switched on, you can choose your preferred lighting mode.

Battery charging

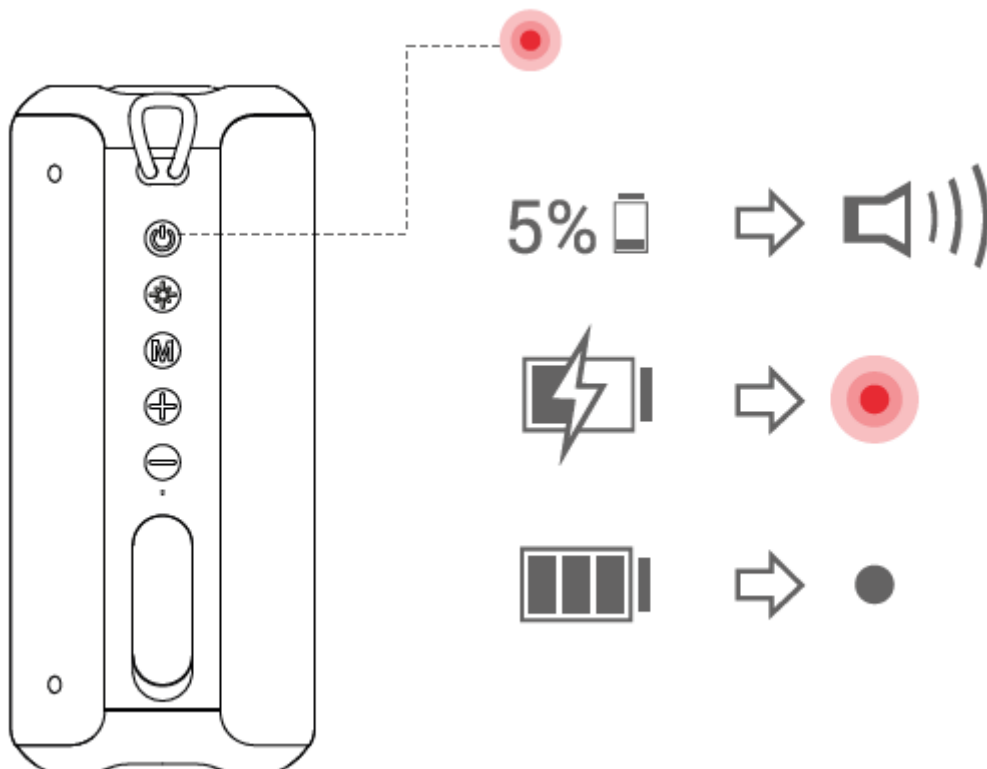

Recommendations:

- Use a 5V 2A AC/DC power adapter. Do not use fast charging chargers for smartphones.

Reset (Force Reset)

You can force the device to shut down by pressing the reset button hidden inside the *Auxiliary Audio In* (minijack connector).

Care and maintenance

- Do not expose your *Soundbliss/TempoRave Speaker* to shock, dust, humidity or high temperatures.
- Do not use corrosive or abrasive cleaning agents.
- Do not disassemble. Any repair should only be carried out by qualified Energy System Technology, S.A. personnel.
- Be sure to keep your *Soundbliss/TempoRave Speaker* switched off when not in use and do not leave it for a long period of time with the battery completely discharged.

Technical specs

Audio

- 2.0 stereo sound system
- Power: 40 W
- 2 x 50 mm full range speakers
- Passive radiators: 2 diaphragms
- Frequency Response: 60 Hz ~ 18 KHz

Bluetooth connectivity

- Bluetooth version 5.3, class II
- Operating frequency: 2.4 GHz
- Maximum signal strength: < 20.00 dBm
- Supports Bluetooth HFP / A2DP / AVRCP profiles
- Compatible with SBC codecs
- Up to 20 metres range
- True Wireless Stereo Technology (TWS)
- Hands-free function
- Compatible with Google/Siri voice assistant

True Wireless Stereo compatible with:

- Soundbliss / TempoRave

Audio inputs

- 3.5 mm stereo analogue jack input

FM radio

- Working frequency: 87.5 ~ 108 MHz
- Automatic station search function

External memory player

- MicroSD and USB external memory player up to 128 GB capacity
- Supported formats: MP3 / WAV
- Supported file system: FAT32 / exFAT
- Folder skip function

Battery

- Capacity: 5000 mAh / 3.7 V
- Type: Lithium-ion
- Battery life at medium volume: 12 hours*.
- Charging time: 3 hours

- Power supply: 5 V / 2 A
- Charging system: USB type C
- This is an approximate figure. Battery life depends on volume selected and type of music played.

Other

- IPX6 Certification

Weight and dimensions

- 842 g
- 200 x 87 x 87 mm

Note: *The battery life varies according to the volume level selected and the type of music played.

Warranty

You can consult the warranty conditions here:

<https://www.energysystem.com/garantia-conditions>